

Chance® Helical Products with 1 1/4" Square Shaft



Features

- 1) Torque Capacity – 4000 Ft Lbs (5400 Km)
- 2) Ultimate Tension Strength 50 kips (222kN)
- 3) Upset Extension Design
- 4) Hot Dipped Galvanized

Benefits

- 1) High load and torque capacity at an economical price
- 2) Upset extension coupler – no separate bolt or coupler required.
- 3) Chance has 60+ years of experience in square shaft products.

Chance® Helical 1 1/4" Round Corner Square Shaft Products (Type SS125 Series)

COMMON LEAD CONFIGURATIONS

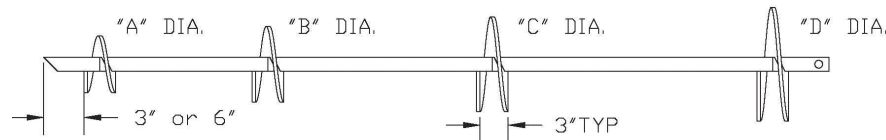

Product Designation	Plate Diameter				Length	Wt (lbs)	HELIX GRADE	COATING
	A	B	C	D				
C1500550	6	8	10	-	5'-0	42	50	GALV
C1500564	8	-	-	-	0'-10	10	50	GALV
C1500564SS	8	-	-	-	0'-10	10	50 /SEA SHELL	GALV
C1500564SSNG	8	-	-	-	0'-10	9	50 /SEA SHELL	NO GALV
C1500545	8	-	-	-	5'-0	33	50	GALV
C1500548	8	10	-	-	5'-0	41	50	GALV
C1500551	8	10	12	-	5'-0	55	50	GALV
C1500565	10	-	-	-	0'-10	13	50	GALV
C1500565SS	10	-	-	-	0'-10	13	50 /SEA SHELL	GALV
C1500565SSNG	10	-	-	-	0'-10	12	50 /SEA SHELL	NO GALV
C1500546	10	-	-	-	5'-0	36	50	GALV
C1500549	10	12	-	-	5'-0	48	50	GALV
C1500552	10	12	14	-	7'-0	57	50	GALV
C1500566	12	-	-	-	0'-10	17	50	GALV
C1500566SS	12	-	-	-	0'-10	17	50 /SEA SHELL	GALV
C1500566SSNG	12	-	-	-	0'-10	16	50 /SEA SHELL	NO GALV
C1500547	12	-	-	-	5'-0	40	50	GALV
C1500567SS	14	-	-	-	0'-10	21	50 /SEA SHELL	GALV
C1500567SSNG	14	-	-	-	0'-10	21	50 /SEA SHELL	NO GALV

CHANCE
Civil Construction

CHANCE™
Since 1912
DOWN. RIGHT. SOLID.

www.abchance.com

ATLAS™
CHANGING HISTORY

www.atlassys.com



210 North Allen Street
Centralia, MO 65240 USA
Phone: 573-682-8414
Fax: 573-682-8660

NOTE: Because Hubbell has a policy of continuous product improvement, we reserve the right to change design and specifications without notice.

©2008 Hubbell Incorporated Printed in USA RGS3M2/10

Bulletin 01-0802
Rev. 2/10

Chance® Helical 1 1/4" Round Corner Square Shaft Products (Type SS125 Series)

COMMON EXTENSION CONFIGURATIONS

PLAIN EXTENSION

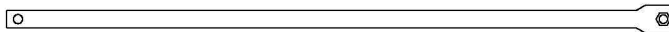

Product Designation	Plate Diameter		Length	Weight (lbs)	HELIX	COATING
	A	B				
C1500553	-	-	3'-4	21		GALV
C1500554	-	-	5'-0	30		GALV
C1500555	-	-	7'-0	39		GALV
C1500556	-	-	10'-0	57		GALV

Chance® Helical 1 1/4" Soil Nail Lead Sections

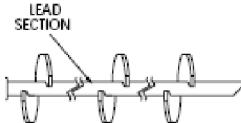

Product Designation	Helix size	Number of Helix	Length	Weight (Lbs)	Helix Grade	Coating
C1500581	6	2	5'	34	50	Galv
C1500582	8	2	5'	38	50	Galv
C1500583	6	3	7'	48	50	Galv
C1500584	8	3	7'	52	50	Galv

* Contact Factory for Non-Galvanized

Chance® Helical 1 1/4" Soil Nail Extensions

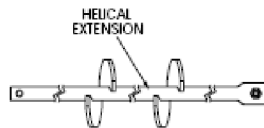

Product Designation	Helix size	Number of Helix	Length	Weight (Lbs)	Helix Grade	Coating
C1500585	6	2	5'	36	50	Galv
C1500586	8	2	5'	40	50	Galv
C1500587	6	3	7'	50	50	Galv
C1500588	8	3	7'	54	50	Galv

* Contact Factory for Non-Galvanized

Chance® Helical 1 1/4" Accessories

Product Designation	Product Description	Weight (Lbs)	Coating
C1500580	1-1/4" Thread Rod Adapter 20" long	11	GALV
PSA15710	1-1/4" Transition to Williams Form # 7 Rod	3	GALV

Chance® Helical 1 1/4" Tooling

Product Designation	Product Description	Weight (Lbs)	Coating
C3031502	1-1/4" Cast Drive Tool	8	GALV